

RoHS2.0

REV.	ECN NO.	APPD.
X1	20231106-006	Alvin Zhang
X2	20240105-001	Alvin Zhang

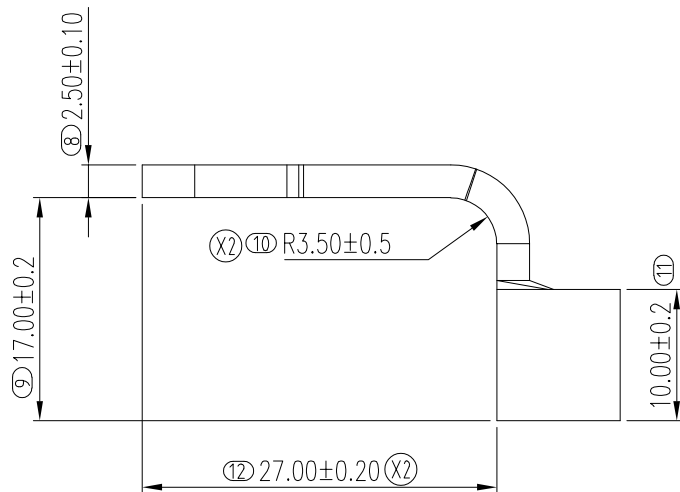
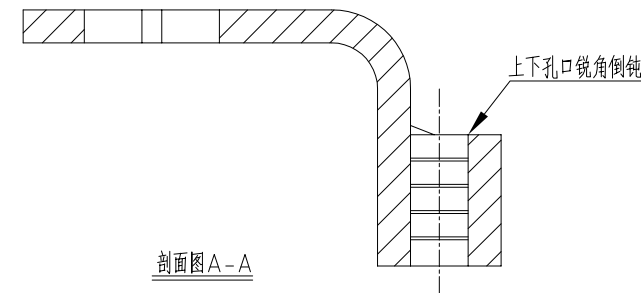
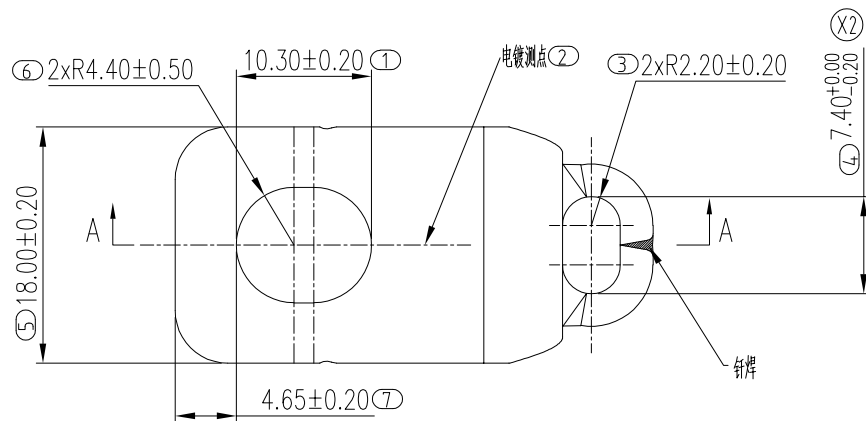

技术要求:

- 1、原材料: T2;
- 2、端子表面应光洁平滑, 不允许有毛刺、裂纹、尖角;
- 3、焊接: 缝隙处钎料焊实, 不能出现气孔、虚焊、不完全熔接、焊瘤、缝隙等现象, 端子压接时此处不得开裂;
- (X2) 4、镀层: 镍打底 $1.5\sim 3.5\mu\text{m}$, 表面镀锡 $1.5\sim 3.5\mu\text{m}$, 镀层应均匀、色泽一致, 表面无露铜、发黑、起层等电镀异常, 镀锡时采用耐高温雾锡工艺;
- (X2) 5、按GB/T2423.17进行96h的耐中性盐雾试验后工件表面不出现锈蚀;
- 6、此产品所包含环境管理物质应符合科信成系统文件QW-QA-10之规定。

TOLERANCES UNLESS OTHERWISE SPECIFIED		UNITS	COCENTRA® 科信成精密技术 (江苏) 有限公司 COCENTRA PRECISION TECHNOLOGY (JIANGSU) Co. LTD			
X.± /	X'.± /	MAT'L	NA	DWG NAME: CUSTOMER DRAWING	TITLE: 接线端子A	
.X± /	.X'± /	FINISH	NA	APPD: David Wang 2024.01.05	PART NO.: 058-000S-0287	
.XX± /	.XX'± /	Q'TY	NA	CKD:	DWG NO.: 307-0000-0452	
THESE DRAWINGS AND SPECIFICATIONS ARE THE PRIOR WRITTEN CONSENT OF COCENTRA PRECISION TECHNOLOGY (JIANGSU) Co. LTD. AND SHALL NOT BE REPRODUCED, COPIED OR USED IN ANY MANNER WITHOUT THE PRIOR WRITTEN CONSENT OF COCENTRA PRECISION TECHNOLOGY (JIANGSU) Co. LTD.				DR: Kevin Lv 2024.01.05		SCALE: 1:1
						SHEET: 1/1
						REV: X2